

Ampule Snapper for WHEATON 1.2, 1.5 and 2mL User Instructions (WHEATON Catalog Number W651000)

The Safest Method to Open Glass Pre-Scored Glass Ampules

- > Increase safety in your lab
- > Reduce the risk of injury
- > Eliminate hand contact with broken glass
- > Quick & easy to use
- > Chemical resistant PBT
- > Autoclavable

An average lab opens over 2,000 ampules per year. The NEW WHEATON Ampule Snapper is specially designed to eliminate hand contact with sharp glass ampules and has the ability to be used on pre-scored ampules or manually scored glass ampules.

With the WHEATON Ampule Snapper, lab personnel's hands do not touch the broken glass ampule which greatly reduces the risk of lacerations.

The Ampule Snapper, made of Polybutylene Terephthalate, has good chemical resistance for cleaning with most solvents and is suitable for autoclave sterilization at 121°C. The Ampule Snapper can be cleaned with a mild detergent and warm water or alcohol. As always, please take the necessary safety precautions prior to opening ampules (i.e. safety glasses, gloves, etc).

Fig 1. Snapper without Ampule

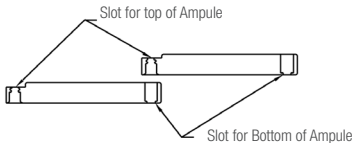

Fig 2. Snapper with Ampule

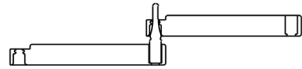

Fig 3. To Snap Twist Top

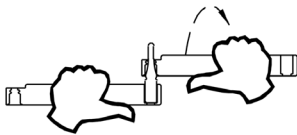
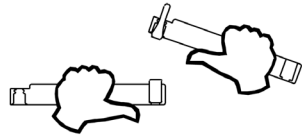

Fig 4. Snapped Ampule



To Use the Ampule Snapper:

1. Insert the base of the sealed glass ampule into the large opening of one of the ampule snapper wands. Please note that both wands are identical. (Fig. 2)
2. Place the smaller opening of the other ampule snapper wand over the sealed tip of the ampule. (Fig. 2)
3. While holding the lower ampule snapper wand still, twist the upper ampule snapper wand in an upward motion to snap the neck of the ampule. (Fig. 3)
4. The tip of the ampule will remain in the upper ampule snapper wand. (Fig. 4) Gently tap the ampule snapper on the edge of the waste container to dislodge the broken tip into the container.
5. The broken ampule bottom containing your sample can remain in the ampule holder while the sample is extracted.
6. Repeat step 4 to remove the broken ampule bottom.